

PART OF THE SOUTHEAST QUARTER OF SECTION 10,
TOWNSHIP 20 NORTH, RANGE 17 EAST, W.M.



LEGEND

- SET 5/8" REBAR W/ CAP
— "CRUSE 36815"
- FOUND PIN & CAP
- x— FENCE
- ⊙ WELL
- ⊕ UTILITY POLE

GRAPHIC SCALE

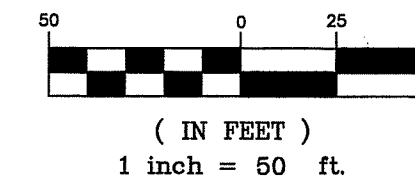

LINE TABLE

L1	S 54°59'00" E	13.74'
L2	S 04°32'40" E	16.54'
L3	S 26°41'34" E	43.92'
L4	S 19°12'21" E	82.54'
L5	S 78°16'49" E	26.50'

AUDITOR'S CERTIFICATE

Filed for record this _____ day of _____
2024, at _____ M., in Book 46 of Surveys at
page(s) _____ at the request of Cruse & Associates.

BRYAN ELLIOTT BY: _____
KITITAS COUNTY AUDITOR

SURVEYOR'S CERTIFICATE

This map correctly represents a survey made by
me or under my direction in conformance with
the requirements of the Survey Recording Act
at the request of PATRICK & CRISTY McKEOWN
in JUNE of 2024.

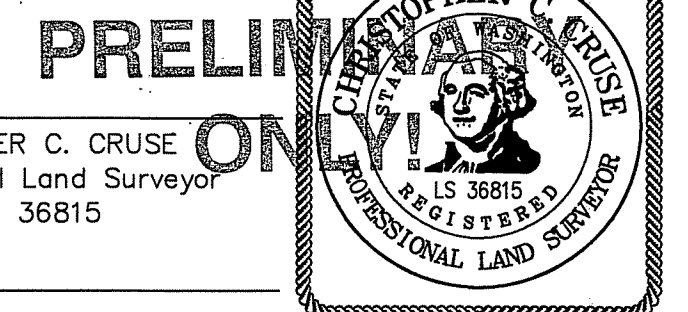

CHRISTOPHER C. CRUSE
Professional Land Surveyor
License No. 36815

DATE _____

CRUSE & ASSOCIATES
PROFESSIONAL LAND SURVEYORS

217 East Fourth Street P.O. Box 959
Ellensburg, WA 98926 (509) 962-8242

McKEOWN PROPERTY

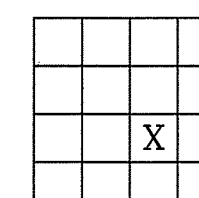

PART OF THE SOUTHEAST QUARTER OF SECTION 10,
TOWNSHIP 20 NORTH, RANGE 17 EAST, W.M.

NOTES:

- 1. THIS SURVEY WAS PERFORMED USING A TOPCON GTS SERIES TOTAL STATION AND/OR SURVEY GRADE GPS. ACCURACY COMPLIES WITH THE REQUIREMENTS SPECIFIED IN WAC 332-130-080 AND 090.
- 2. THIS SURVEY MAY NOT SHOW ALL EASEMENTS OR IMPROVEMENTS WHICH MAY PERTAIN TO THIS PROPERTY.
- 3. KITTITAS COUNTY WILL NOT ACCEPT PRIVATE ROADS FOR MAINTENANCE AS PUBLIC STREETS OR ROADS UNTIL SUCH STREETS OR ROADS ARE BROUGHT INTO CONFORMANCE WITH CURRENT COUNTY ROAD STANDARDS. THIS REQUIREMENT WILL INCLUDE THE HARD SURFACE PAVING OF ANY STREET OR ROAD SURFACED ORIGINALLY WITH GRAVEL.
- 4. FOR SECTION SUBDIVISION, CORNER DOCUMENTATION, BASIS OF BEARINGS AND ADDITIONAL INFORMATION, SEE BOOK 22 OF SURVEYS, PAGE 244. ALL CORNERS SHOWN AS FOUND ARE WITHIN 0.3' OF CALCULATED POSITION.
- 5. THE PURPOSE OF THIS SURVEY IS TO DELINEATE NEW PROPERTY BOUNDARIES AND PROVIDE DESCRIPTIONS FOR KITTITAS COUNTY BOUNDARY LINE ADJUSTMENT APPLICATION BL-24-00014.

LEGAL DESCRIPTIONS

ORIGINAL PARCELS –

LOT A OF SURVEYS FILED IN BOOK 22 OF SURVEYS, PAGE 244, EXCEPTING THAT PORTION DESCRIBED IN ORDER GRANTING SUMMARY JUDGMENT FOR QUIET TITLE, EJECTMENT AND INJUNCTION, FILED MAY 3, 2013 UNDER KITTITAS COUNTY SUPERIOR COURT CASE NO. 12-2-00135-1

AND

LOT B OF SURVEY FILED IN BOOK 22 OF SURVEYS, PAGE 244.

REVISED PARCEL DESCRIPTIONS

PARCEL 1

PARCEL 1 OF THAT CERTAIN SURVEY RECORDED SEPTEMBER __, 2024, IN BOOK 46 OF SURVEYS AT PAGES _____, UNDER AUDITOR'S FILE NO. 202409_____, RECORDS OF KITTITAS COUNTY, WASHINGTON; BEING A PORTION OF THE WEST HALF OF THE SOUTHEAST QUARTER OF SECTION 10, TOWNSHIP 20 NORTH, RANGE 17 EAST, W.M., IN THE COUNTY OF KITTITAS, STATE OF WASHINGTON.

PARCEL 2

PARCEL 2 OF THAT CERTAIN SURVEY RECORDED SEPTEMBER __, 2024, IN BOOK 46 OF SURVEYS AT PAGES _____, UNDER AUDITOR'S FILE NO. 202409_____, RECORDS OF KITTITAS COUNTY, WASHINGTON; BEING A PORTION OF THE WEST HALF OF THE SOUTHEAST QUARTER OF SECTION 10, TOWNSHIP 20 NORTH, RANGE 17 EAST, W.M., IN THE COUNTY OF KITTITAS, STATE OF WASHINGTON.

EASEMENT M

EASEMENT M AS DELINEATED ON THAT CERTAIN SURVEY RECORDED SEPTEMBER __, 2024, IN BOOK 46 OF SURVEYS AT PAGES _____, UNDER AUDITOR'S FILE NO. 202409_____, RECORDS OF KITTITAS COUNTY, WASHINGTON; BEING ACROSS A PORTION OF THE WEST HALF OF THE SOUTHEAST QUARTER OF SECTION 10, TOWNSHIP 20 NORTH, RANGE 17 EAST, W.M., IN THE COUNTY OF KITTITAS, STATE OF WASHINGTON; AFFECTING PARCEL 1 OF SAID SURVEY.

EASEMENT N

EASEMENT N AS DELINEATED ON THAT CERTAIN SURVEY RECORDED SEPTEMBER __, 2024, IN BOOK 46 OF SURVEYS AT PAGES _____, UNDER AUDITOR'S FILE NO. 202409_____, RECORDS OF KITTITAS COUNTY, WASHINGTON; BEING ACROSS A PORTION OF THE WEST HALF OF THE SOUTHEAST QUARTER OF SECTION 10, TOWNSHIP 20 NORTH, RANGE 17 EAST, W.M., IN THE COUNTY OF KITTITAS, STATE OF WASHINGTON; AFFECTING PARCEL 1 OF SAID SURVEY.

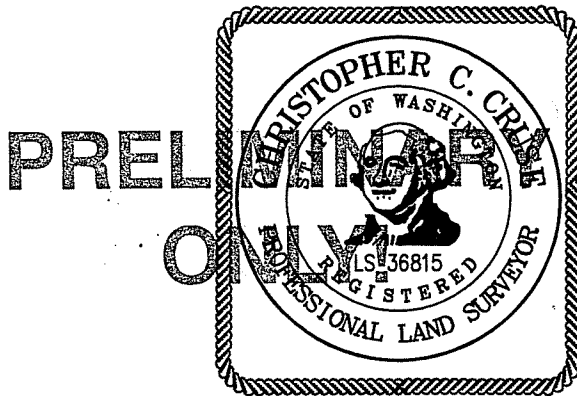

AUDITOR'S CERTIFICATE

Filed for record this _____ day of _____,
2024, at _____ M., in Book 46 of Surveys at
page(s) _____ at the request of Cruse & Associates.

BRYAN ELLIOTT BY: _____
KITTITAS COUNTY AUDITOR

CRUSE & ASSOCIATES
PROFESSIONAL LAND SURVEYORS
217 East Fourth Street P.O. Box 959
Ellensburg, WA 98926 (509) 962-8242

McKEOWN PROPERTY